

a-a pictorial

Size to suit structure (Min 150mm Max 300mm - For sizes exceeding 300mm refer to sheet 1000) Parapet turnout & screw fixed to ALUCOBOND fixing angle

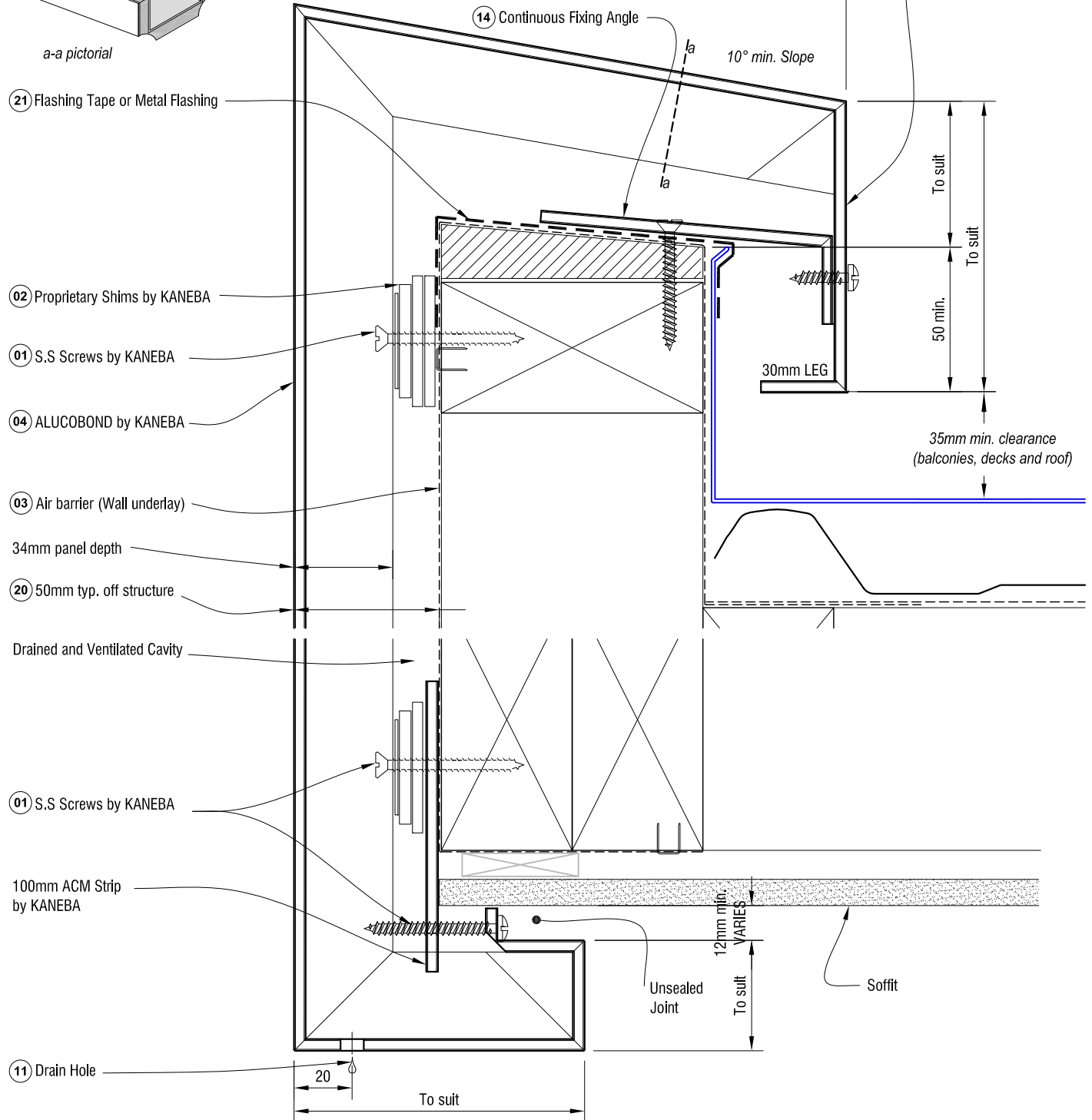

NOTE

- (XX) Notations for these references are available in Section 12 of the Alucobond Fixed Cassette System Manual.

	DRAWING TITLE	NOTES:	DRAWING STATUS	
	FASCIA AND SOFFIT DETAIL	THIS DRAWING FORMS PART OF AND MUST BE READ WITH THE ALUCOBOND FIXED CASSETTE SYSTEM MANUAL.	ARCHITECTURAL RESOURCE	SHEET NO. 10
			SCALE: 1:2	DATE: MARCH 2013